

Parts for Disaster System, 2

Slot for Umbilical

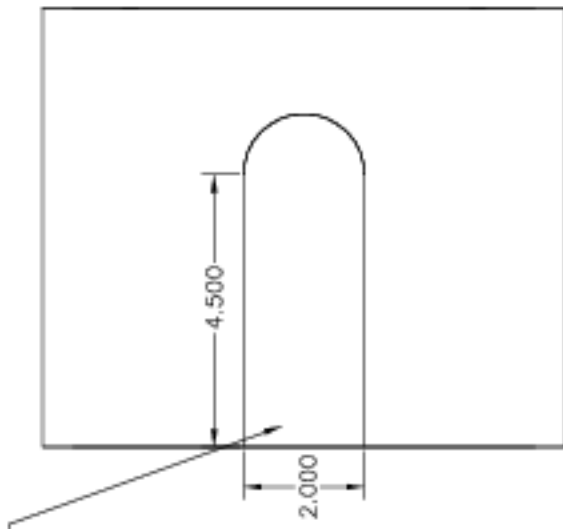

Four holes tapped for 1/4-20 screws on 4.0025-in circle. (to mate with holes in part 11-264)

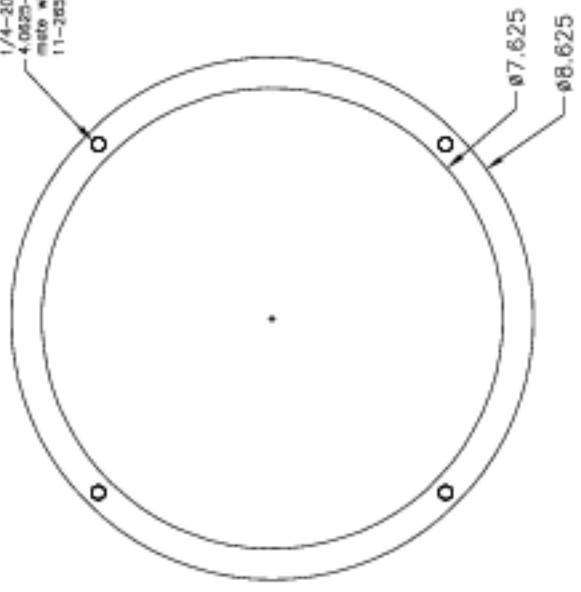

Part 11-264a, Upright of Cup for disaster system. Make of 1/2-in (wall) aluminum pipe. 1 reqd.

Tenn. State Univ.

CASS 2-m AST Project

07/22/02 J.A.E. AST-11-P13