

Fabrication and machining of cylindrical motor adapter made from parts 10-054, 10-055, & 10-056.

Motor-Mount Cylinder

12 holes tapped for 1/4-20, evenly spaced on R3.8375 circle coaxial with bolt circle on bottom of part to within 0.005 inches. These screw holes should be roughly coaxial with those in the bottom plate (± 2 degrees along cylinder).

ϕ 0.003

Weld seam on inside of part with 6 welds, evenly spaced along seam, 1/2-inch long, in chamfers. Weld seam on outside with 1/8-inch fillet welds, 1-inch long, broken by 1/2-inch gaps.

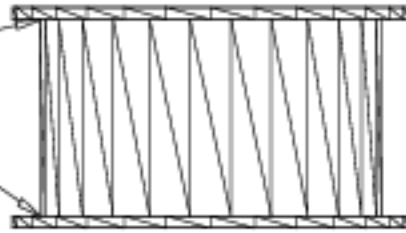

\square 0.003
// 0.005 A

12 body clearance holes for 1/4-inch screws, evenly spaced on R3.8375 circle centered on part to within 0.02 inches.

ϕ 0.003

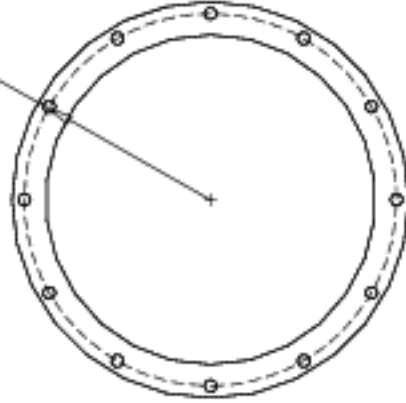

Top View

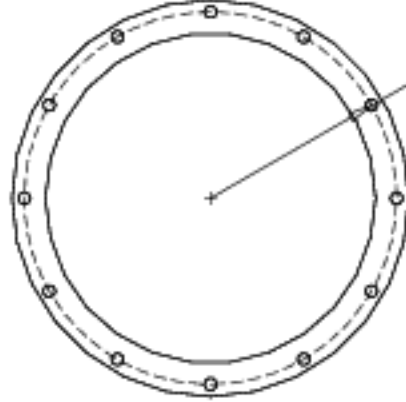

Bottom View

Tenn. State Univ.	
CASS 2-m AST Project	
08/13/97	AST-10-R10
J.A.E.	