

Central Cylinder of Tube

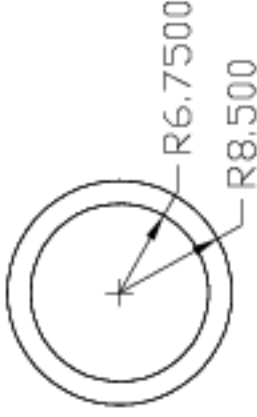

Part 5-005, Lower Central Ring. This is made of 0.25-inch steel, is welded to the lower edge of the central cylinder, and is bolted into the pocket in the mirror cell defined in drawing AST-05-R10. (1 reqd)



Part 5-004, Upper Central Ring. This ring is made of 0.25-inch steel and is welded to the top end of the central cylinder. It will have 6 screw holes (not shown) for attaching the instrument head (not part of telescope). (1 reqd)

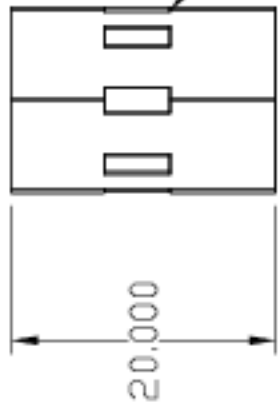

Ignore these holes; they are unnecessary.

Part 5-003, Central Cylinder. This is a 14-inch diameter pipe with 0.25-inch thick walls. (1 reqd)

Tenn. State Univ.	
CASS 2-m AST Project	
08/19/97	AST-05-P17
J.A.E.	